

IP-SEI-018C36C9POM16

Monitored Rack kWh PDU, 0U, per outlet kWh metering, 3.6kW, outlets (18)C13 and (6)C19, input C20 (1x16A), without input cord



037286VIM11- IPSEI018C36OM16

MONITORED PDU

IP-SEI-018C36C9POM16

SPECIFICATIONS

DIMENSIONS	L x W x D = 1105 x 65 x 52.5 mm (0U) (excl. strain relief, mounting & cable bending radius)
ENCLOSURE	Profile color black, aluminium with stainless steel covers (IP20)
MOUNT	Toolless mount buttons (brackets not included) (distance=800, positions=152, 952mm)
POWER INPUT	single phase 16 A, 230VAC - 50/60Hz
CABLE ENTRY	power entry front-side top
CABLE & PLUG	C20 16A chassis
CONNECTIVITY	databus: 2 x RJ45 Ethernet: RJ45 sensorport: RJ11 USB
INPUT METERING	volt, ampere, kWh, power factor
METERED OUTLETS	24 times volt, ampere, kWh, power factor
FUSES	n/a
DISPLAY	LCD display with backlight and configurable orientation
OUTLETS	18 x IEC 60320 C13 , 6 x IEC 60320 C19

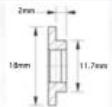

Summary

- vertical PDU (0 U)
- single phase 16 A
- metered input
- metered outlets
- 24 outlets