

IP-SEA-318C36C9POM32

Managed Rack kWh PDU, 0U, per outlet kWh metering, 7.2kW, outlets (18)C13 and (6)C19, input plug EN 60309 (1x32A), cord 3m



037294VIB13- IPSEA318C36OM32

MANAGED PDU

IP-SEA-318C36C9POM32

SPECIFICATIONS

DIMENSIONS L x W x D = 1410 x 65 x 52.5 mm (0U)
(excl. strain relief, mounting & cable bending radius)

ENCLOSURE Profile color black, aluminium with stainless steel covers
(IP20)

MOUNT Toolless mount buttons (brackets not included)
(distance=1155, positions=127, 1282mm)

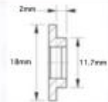

POWER INPUT single phase 32 A, 230VAC - 50/60Hz

CABLE ENTRY power entry front-side top

CABLE & PLUG Power lead (3G6 halogenfree) with CEE plug 3,0m (strain relief height 2,5cm)



CONNECTIVITY databus: 2 x RJ45 | Ethernet: RJ45 | sensorport: RJ11 | USB

INPUT METERING volt, ampere, kWh, power factor

SWITCHED OUTLETS 24 times bistable close to zero crossing switching relays

METERED OUTLETS 24 times volt, ampere, kWh, power factor

FUSES 3 x thermal breaker 16A (ETA)

DISPLAY LCD display with backlight and configurable orientation

OUTLETS 18 x IEC 60320 C13 , 6 x IEC 60320 C19